



RoHS - compliant

P @ 70°C T.C.R. ppm / °C	Tol. J = 5% H = 3% G = 2% F = 1% Type	Working Voltage	Withst. Voltage	Ω	E	Packing Unit
		Vrms max.	Vac			Pcs. / Reel ** Bulk
3.00 W / 100 ... 30ppm	3 SM J (H / F)	173	1000	0.1 ... 10k	E-12	700
0.5 W / 100 ppm 25 ... 125°C	WWH-050 G (F / J)	7.071	500	5 ... 50	E-24	2 500
1.0 W / 100 ppm 25 ... 125°C	WWH-100 G (F / J)	9.055	500	5 ... 82	E-24	2 000
2.0 W / 100 ppm 25 ... 125°C	WWH-200 G (F / J)	15.49	500	5 ... 120	E-24	1 500
3.0 W / 100 ppm 25 ... 125°C	WWH-300 G (F / J)	30.00	500	5 ... 300	E-24	** 500

		3 SM	WWH-50	WWH-100	WWH-200	WWH-300
Therm. resistance	Therm. Widerstand	50°C/W				
Derating	Lastminderung	Linear from 70°C to 220°C	70°C to 275°C	70°C to 275°C	70°C to 275°C	70°C to 275°C
Insulat. resistance	Isolationswiderstand	1 000 M Ω minimum	20 M Ω min.	20 M Ω min.	20 M Ω min.	20 M Ω min.
Short time overl.	Kurzzeitige Ueberlast	5x Pn 5 sec.	10x Pn 5 sec.	10x Pn 5 sec.	10x Pn 5 sec.	10x Pn 5 sec.
Non inductive	Induktionsarme Ausf.	Ayrton Perry syst. max. 4k7				

3 SM Serie

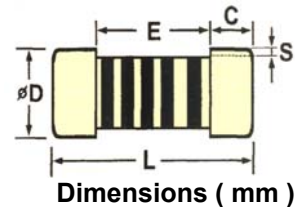
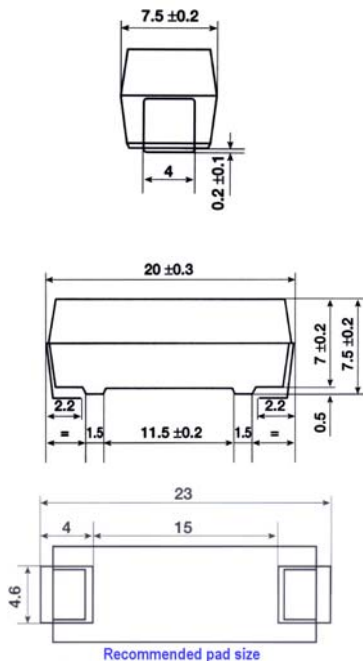

WWH Serie	L ± 0.3	C ± 0.3	D ± 0.3	E ± 0.3	S ± 0.3
WWH-050	6.5	1.8	2.7	2.9	0.3
WWH-100	9.5	2.2	3.6	4.8	0.4
WWH-200	11.2	2.6	4.7	6.0	0.5
WWH-300	15.2	2.6	5.3	10.0	0.5

Measuring Point

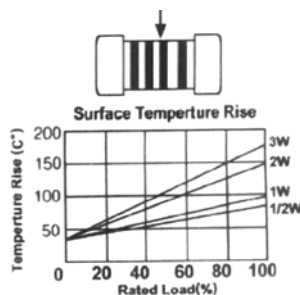

Derating Curve

